



Splash Scheme



©Tarkett Hospitality

**Hilton Garden Inn - (B) Splash Scheme
Guestroom Broadloom
CP-01**

1 repeat shown- not to scale

Product Information

Style / Color Number	HG32B / 316
Product Type	Broadloom
Construction	Multi-Level Pattern Cut/Loop
Fiber	Lextron Enviro-Green Nylon
Dye Method	100 % Solution Dyed
Primary Backing	Woven Polypropylene
Secondary Backing	Action Bac

Specifications

Size	13'
Gauge	1/10
Stitches per Inch	11
Tufted Weight	32oz per sq/yd
Finished Pile Thickness	.247 inches average
Pattern Repeat	78" x 46.91"
Total Overall Thickness	.352 inches average

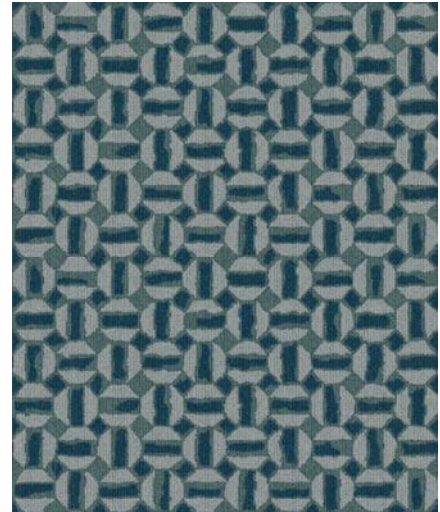

Performance

Traffic Class (TARR)	Heavy
Pill Test	Pass
Radiant Panel	Class I
Flammability	ASTM E 648 Class I
Smoke Density	ASTM E 662 Less than 450
LEED Info	Green Label Plus Certified – GLP2380

Warranty **10 Year Limited Warranty**

Enviro-Green yarn has 10% pre-consumer recycled content. 
Recommended for heavy (public space) carpet traffic levels.

NOTE: Due to the manufacturing process of a tip shear product, the finished yarn weight will vary more than normal manufacturing tolerances and side match cannot be guaranteed.

Carpet should be installed in accordance with the Carpet and Rug Institute's standard CRI-104.
 Carpet must be over manufacturer's recommended pad.

Pattern streaks and banding are visually apparent streaking in patterned carpet resulting from linear juxtaposition of pattern elements visible in both length and width direction.
IT IS NOT A CARPET DEFECT, but is inherent in solution dyed graphic and cut/loop patterns.

All Specifications subject to normal manufacturing tolerance.

**Hilton Garden Inn - (B) Splash Scheme
Elevator Lobby Carpet Tile
CP-11.ALT**

Product Information

Style / Color Number	HG42T / 368
Product Type	Carpet Tile
Construction	Multi-Level Pattern Cut/Loop
Fiber	Lextron Enviro-Green Nylon
Dye Method	100 % Solution Dyed
Primary Backing	Woven PET
Secondary Backing	Flex Aire

Specifications

Tile Size	24" x 24"
Gauge	1/10
Stitches per Inch	9
Tufted Weight	28 oz per sq/yd
Total Weight	125 oz
Finished Pile Thickness	.250 inches average
Pattern Repeat	N/A
Installation Method	Vertical Ashlar

Performance

Traffic Class (TARR)	Heavy
Pill Test	Pass
Radiant Panel	Class I
Flammability	ASTM E 648 Class I
Smoke Density	ASTM E 662 Less than 450
Electrostatic Propensity	Less Than 3.5kv
LEED Info	Green Label Plus Certified – GLP8320

Warranty Available **10 Year Limited Warranty**

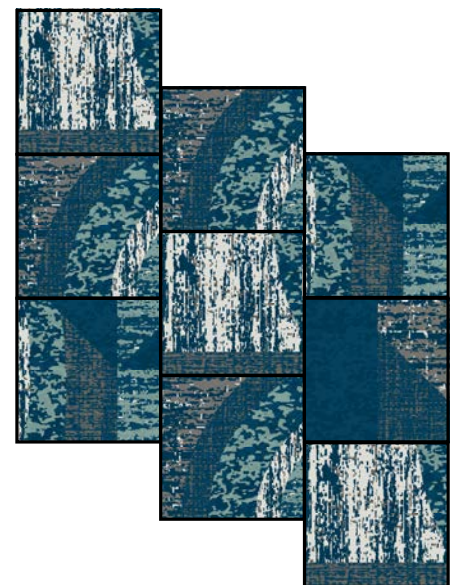

**24" x 24" RANDOM CUT TILE
VERTICAL ASHLAR INSTALLATION**

Enviro-Green yarn has 10% pre-consumer recycled content. 
Recommended for heavy (public space) carpet traffic levels.

NOTE: Due to the manufacturing process of a tip shear product, the finished yarn weight will vary more than normal manufacturing tolerances and side match cannot be guaranteed.

Carpet should be installed in accordance with the Carpet and Rug Institute's standard CRI-104.
Carpet must be over manufacturer's recommended pad.

Pattern streaks and banding are visually apparent streaking in patterned carpet resulting from linear juxtaposition of pattern elements visible in both length and width direction.
IT IS NOT A CARPET DEFECT, but is inherent in solution dyed graphic and cut/loop patterns.

All Specifications subject to normal manufacturing tolerance.

Hilton Garden Inn - (B) Splash Scheme Resilient Flooring

Resilient Flooring Product Information

Hilton Tag# RF-01 ERT @ Guestroom (Optional)
RF-11 ERT @ BOH

Style Number ACCRE-0015-7X48-VT
Color Fawn Elm 0015
Product Type LVT/ERT - Enhanced Resilient Tile
Size 7" W x 48" L
Carton Size 23.64 sq ft per carton
Installation Pattern: Stagger

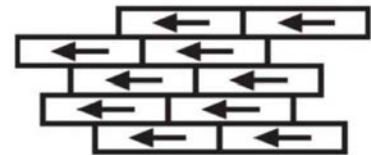

INSTALL: STAGGER

Hilton Tag# (B) VCT-10 VCT @ Public Area

Style Number VCT II
Color 509 Pewter
Product Type Vinyl Composition Tile
Size 12" x 12" x 1/8" Thick
Carton Size 45 sq ft per carton (45 tiles/carton)



Hilton Garden Inn - (B) Splash Scheme Wall Base Options

Resilient Wall Base Product Information

Hilton Tag# B-01 Resilient Base @ Guestroom
B-10 Resilient Base @ Corridor

Style Number MW-20-F
Color 20 Charcoal
Product Type Reveal - Millwork Wall Base
Size 4"-1/4"H x .250" Thick x 8 ft. Lengths
Carton Size 64 ft per carton
Installation Direct Glue

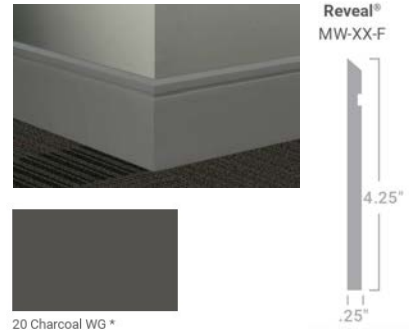

Hilton Tag# B-11 Resilient Base @ Fitness Area

Style Number MW-48-F
Color 48 Grey
Product Type Reveal - Millwork Wall Base
Size 4"-1/4"H x .250" Thick x 8 ft. Lengths
Carton Size 64 ft per carton
Installation Direct Glue

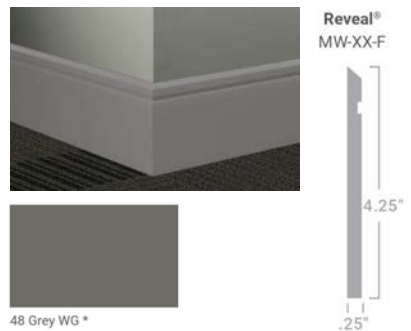

Carpet Base Product Information

Hilton Tag# B-01.ALT Carpet Base @ Guestroom
B-10.ALT Carpet Base @ Corridor

Style Number 728S
Color 5529
Product Type Cut pile bound carpet base
Size 4"H x 12' Strips
Carton Size N/A
Installation Direct Glue



Enviro-Green yarn has 10% pre-consumer recycled content. 
Recommended for heavy (public space) carpet traffic levels.

NOTE: Due to the manufacturing process of a tip shear product, the finished yarn weight will vary more than normal manufacturing tolerances and side match cannot be guaranteed.

Carpet should be installed in accordance with the Carpet and Rug Institute's standard CRI-104.
Carpet must be over manufacturer's recommended pad.

Pattern streaks and banding are visually apparent streaking in patterned carpet resulting from linear juxtaposition of pattern elements visible in both length and width direction.
IT IS NOT A CARPET DEFECT, but is inherent in solution dyed graphic and cut/loop patterns.

All Specifications subject to normal manufacturing tolerance.



CP-01
HG32B - 316
13' WIDE BROADLOOM
78" X 46.81" REPEAT
GUESTROOMS



CP-10
HG36B - 368
12' WIDE BROADLOOM
144" X 169.60" REPEAT
CORRIDORS



CP-11
HG40B - 368
12' WIDE BROADLOOM
144" X 169.60" REPEAT
ELEVATOR LOBBIES



CP-12
HG44B - 368
12' WIDE BROADLOOM
144" X 176" REPEAT
MEETING

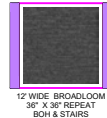

CP-13
HG48B - 680
12' WIDE BROADLOOM
36" X 36" REPEAT
BOH & STAIRS

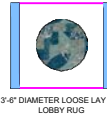

PA-900
HG52R - 368
13'-6" DIAMETER LOOSE LAY RUG
LOBBY RUG

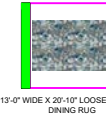

PA-901
HG54R - 368
13'-0" WIDE X 20'-10" LOOSE LAY RUG
DINING RUG

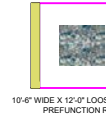

PA-902
HG56R - 368
10'-4" WIDE X 12'-0" LOOSE LAY RUG
PREFUNCTION RUG



BF-01
ACCORE
FAWN ELM
LUXURY VINYL TILE
7" X 48" #ASHLAR)
GUESTROOM (OPTION)



RE-11
ACCORE
FAWN ELM
LUXURY VINYL TILE
7" X 48" #ASHLAR)
BOH

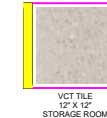

VCT-10
VCT II
509 PEWTER
12" X 12"
STORAGE ROOM



CP-50
HG58R - 368
12' WIDE BROADLOOM
144" X 214.40" REPEAT
LOBBY (RENOVATION)



CP-51
HG60R - 368
12' WIDE BROADLOOM
144" X 111.20" REPEAT
DINING & PREFUNCTION (RENOVATION)



B-01
MW-20-F CHARCOAL
4.25" VINYL BASE
GUESTROOMS



B-10
MW-20-F CHARCOAL
4.25" VINYL BASE
PUBLIC SPACES

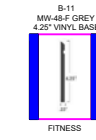

B-11
MW-48-F GREY
4.25" VINYL BASE
FITNESS

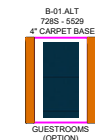

B-01 ALT
728S - 5529
4" CARPET BASE
GUESTROOMS
(OPTION)



B-10 ALT
728S - 5529
4" CARPET BASE
PUBLIC SPACES
(OPTION)

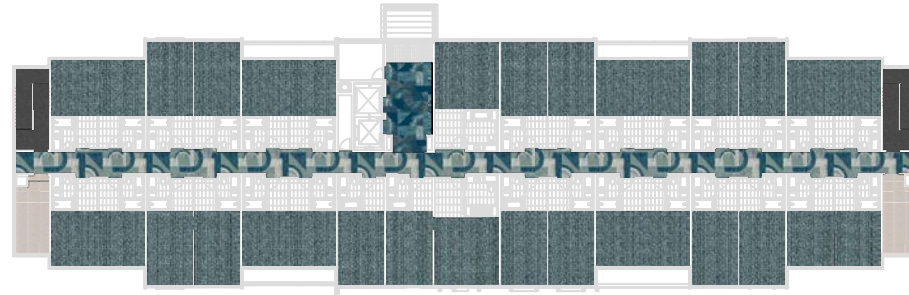

2ND - 6TH FLOOR PLAN
2 TYPICAL FLOORS

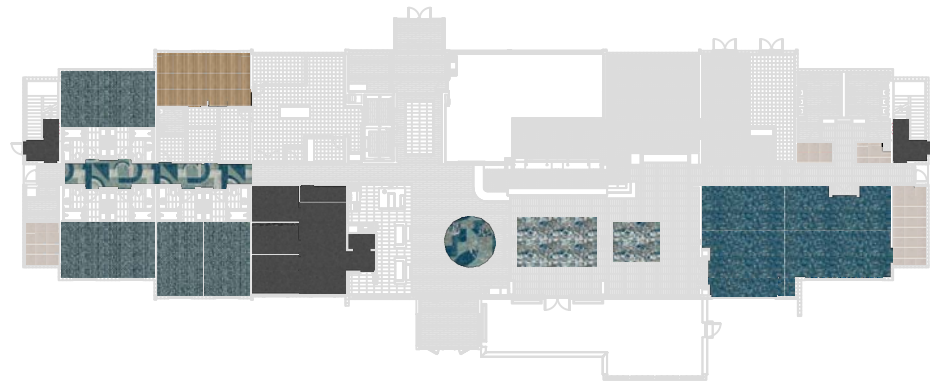

1ST FLOOR PLAN

GENERAL NOTES

- 1) This drawing and designs contained therein are the sole property of Tarkett Hospitality Carpet Mills, Inc.
- 2) The red dotted lines indicate known seams. Due to mill sizes and unexpected conditions that may arise, adjustment seams may become necessary during installation. Locations of cross seams are approximate. Actual layout may vary based on roll sizes.
- 3) All contractors using this drawing will be responsible for verifying all dimensions and yardage requirements. Tarkett Hospitality Carpet Mills, Inc. will not be held responsible for final yardage requirements.
- 4) These drawings are used to show the interior design intent only and should not be used for construction purposes.
- 5) Patterned Products require experienced and knowledgeable installation technicians. Please ensure that installers have proper equipment and are familiar with Tarkett's Installation Guidelines. Please contact Technical Services for questions to request a copy of the Installation Guidelines.
Doye Daughler @ (706) 561-3554
John Cox @ (706) 260-3054

Seam Lines are indicated by red dashed lines.
This plan must be field verified for measurement accuracy.

Rev. #	Description	Date

Approved By:
Date:



TARKETT HOSPITALITY
285 KRAFT DRIVE
DALTON, GA. 30721
(800) 871-3211

Project Name and Address
HILTON GARDEN INN
SPLASH PROTOTYPE
BROADLOOM

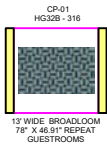

CP-01
HG32B - 316
13" WIDE BROADLOOM
78" X 46.81" REPEAT
GUESTROOMS



CP-10
HG36B - 368
12" WIDE BROADLOOM
144" X 216.80" REPEAT
CORRIDORS



CP-11
HG40B - 368
12" WIDE BROADLOOM
144" X 189.60" REPEAT
ELEVATOR LOBBIES



CP-12
HG44B - 368
12" WIDE BROADLOOM
144" X 176" REPEAT
MEETING



CP-13
HG48B - 080
12" WIDE BROADLOOM
36" X 36" REPEAT
BOH & STAIRS

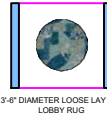

PA-000
HG52R - 368
13'-6" DIAMETER LOOSE LAY RUG
LOBBY

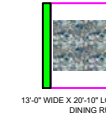

PA-901
HG54R - 368
13'-0" WIDE X 20'-10" LOOSE LAY RUG
DINING RUG



PA-902
HG56R - 368
10'-4" WIDE X 12'-0" LOOSE LAY RUG
PREFUNCTION RUG



BF-01
ACCORE
FAWN ELM
LUXURY VINYL TILE
7" X 48" @ASHLAR)
GUESTROOM (OPTION)



RE-11
ACCORE
FAWN ELM
LUXURY VINYL TILE
7" X 48" @ASHLAR)
BOH

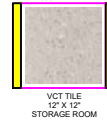

VCT-10
VCT II
509 PEWTER
VCT TILE
12" X 12"
STORAGE ROOM



CP-50
HG58R - 368
12" WIDE BROADLOOM
144" X 214.40" REPEAT
LOBBY (RENOVATION)



CP-51
HG60R - 368
12" WIDE BROADLOOM
144" X 111.20" REPEAT
DINING & PREFUNCTION (RENOVATION)



B-01
MW-20-F CHARCOAL
4.25" VINYL BASE
GUESTROOMS



B-10
MW-20-F CHARCOAL
4.25" VINYL BASE
PUBLIC SPACES

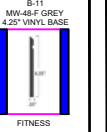

B-11
MW-48-F GREY
4.25" VINYL BASE
FITNESS

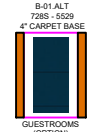

B-01 ALT
728S - 5029
4" CARPET BASE
GUESTROOMS
(OPTION)

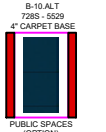

B-10 ALT
728S - 5029
4" CARPET BASE
PUBLIC SPACES
(OPTION)



2ND - 5TH FLOOR PLAN
2 TYPICAL FLOORS

2217 FLOOR
775 FLOOR

B-01
4.25" VINYL BASE
GUESTROOMS

B-10
4.25" VINYL BASE
PUBLIC SPACES

RESILIENT WALL BASE WITH CARPET BASE OPTION
If B-01 ALT carpet base is used in guestrooms it is to be used in carpeted areas only. B-01 to be used in entries.

570 FLOOR
1647 FLOOR
151 FLOOR
827 FLOOR

B-01
4.25" VINYL BASE
GUESTROOM ENTRIES

B-01 ALT
4" CARPET BASE
GUESTROOMS

B-10
4.25" VINYL BASE
PUBLIC SPACES

B-10 ALT
4" CARPET BASE
PUBLIC SPACES

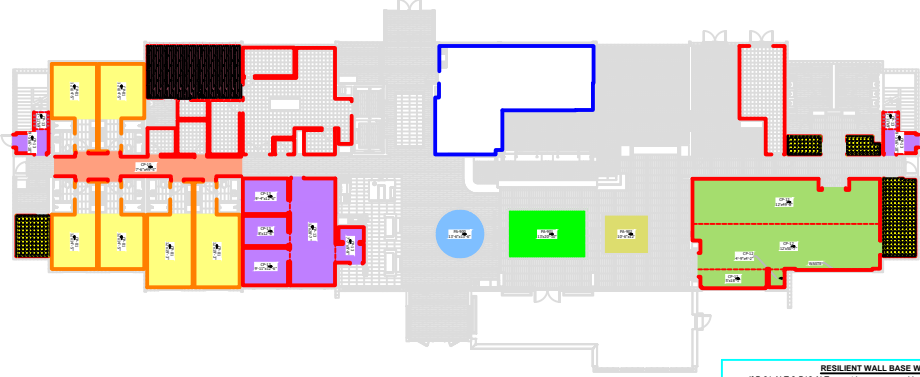

1ST FLOOR PLAN

408 FLOOR
1085 FLOOR
1312 FLOOR

B-01
4.25" VINYL BASE
GUESTROOMS

B-10
4.25" VINYL BASE
PUBLIC SPACES

B-11
4.25" VINYL BASE
FITNESS

RESILIENT WALL BASE WITH CARPET BASE OPTION
If B-01 ALT & B-10 ALT carpet bases are used in guestrooms & public spaces they are to be used in carpeted areas only. B-01 & B-10 to be used at hard surfaces.

105 FLOOR
301 FLOOR
576 FLOOR
518 FLOOR

B-01
4.25" VINYL BASE
GUESTROOM ENTRIES

B-01 ALT
4" CARPET BASE
GUESTROOMS

B-10
4.25" VINYL BASE
PUBLIC SPACES

B-10 ALT
4" CARPET BASE
PUBLIC SPACES

GENERAL NOTES

- 1) This drawing and designs contained therein are the sole property of Tarkett Hospitality Carpet Mills, Inc.
- 2) The red dotted lines indicate known seams. Due to mill sizes and unexpected conditions that may arise, adjustment seams may become necessary during installation. Locations of cross seams are approximate. Actual layout may vary based on roll sizes.
- 3) All contractors using this drawing will be responsible for verifying all dimensions and yardage requirements. Tarkett Hospitality Carpet Mills, Inc. will not be held responsible for final yardage requirements.
- 4) These drawings are used to show the interior design intent only and should not be used for construction purposes.
- 5) Patterned Products require experienced and knowledgeable installation technicians. Please ensure that installers have proper equipment and are familiar with Tarkett's Installation Guidelines. Please contact Technical Services for questions to request a copy of the Installation Guidelines. Doye Daughler @ (706) 661-3554 John Cox @ (706) 260-3054

Seam Lines are indicated by red dashed lines.
This plan must be field verified for measurement accuracy.

Rev. #	Description	Date

Approved By: _____
Date: _____



TARKEET HOSPITALITY
285 KRAFT DRIVE
DALTON, GA. 30721
(800) 871-3211

Project Name and Address
HILTON GARDEN INN
SPLASH PROTOTYPE
BROADLOOM

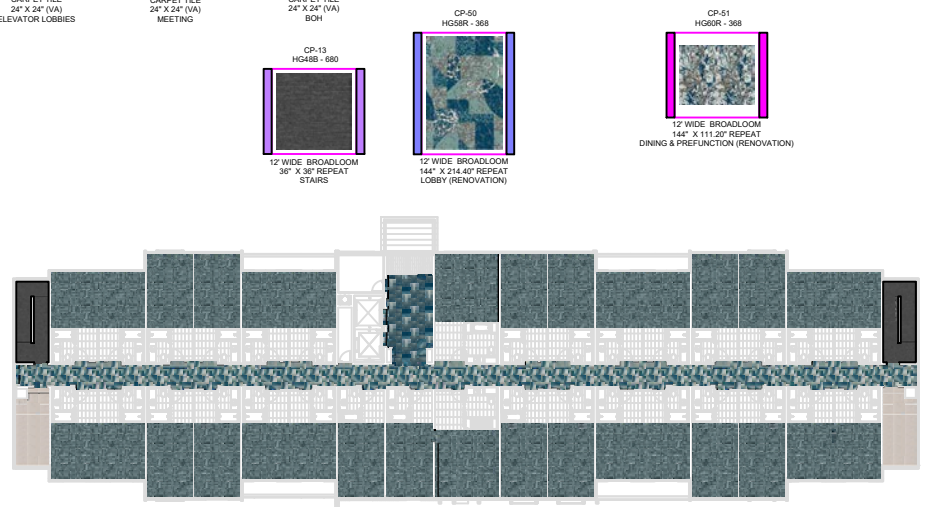
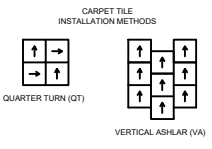
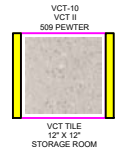
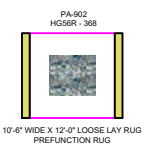
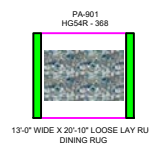
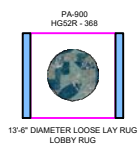
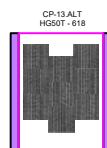
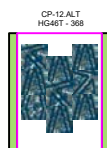
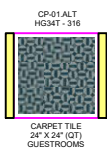

2ND - 6TH FLOOR PLAN
2 TYPICAL FLOORS

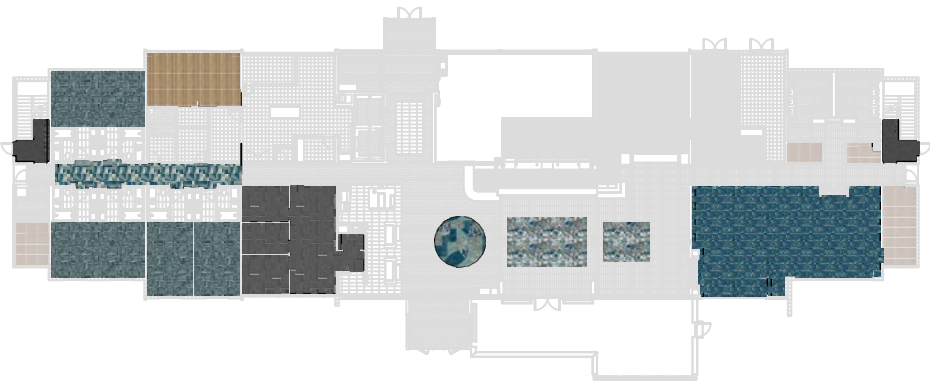

1ST FLOOR PLAN

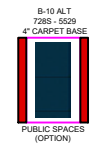
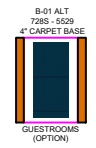
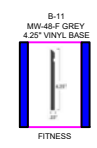
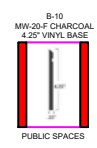
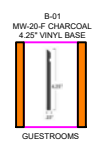

GENERAL NOTES

- 1) This drawing and designs contained therein are the sole property of Tarkett Hospitality Carpet Mills, Inc.
- 2) The red dotted lines indicate known seams. Due to mill sizes and unexpected conditions that may arise, adjustment seams may become necessary during installation. Locations of cross seams are approximate. Actual layout may vary based on roll sizes.
- 3) All contractors using this drawing will be responsible for verifying all dimensions and yardage requirements. Tarkett Hospitality Carpet Mills, Inc. will not be held responsible for final yardage requirements.
- 4) These drawings are used to show the interior design intent only and should not be used for construction purposes.
- 5) Patterned Products require experienced and knowledgeable installation technicians. Please ensure that installers have proper equipment and are familiar with Tarkett's Installation Guidelines. Please contact Technical Services for questions to request a copy of the Installation Guidelines.
Doye Daughler @ (706) 561-3554
John Cox @ (706) 260-3054

Seam Lines are indicated by red dashed lines.
This plan must be field verified for measurement accuracy.

Rev. #	Description	Date

Approved By: _____
Date: _____

TARKETT HOSPITALITY
285 KRAFT DRIVE
DALTON, GA. 30721
(800) 871-3211

Project Name and Address

**HILTON GARDEN INN
SPLASH PROTOTYPE**
CARPET TILE



CP-01 ALT
HG34T - 316
CARPET TILE
24" X 24" (GT)
GUESTROOMS



CP-10 ALT
HG38T - 368
CARPET TILE
24" X 24" (VA)
CORRIDORS



CP-11 ALT
HG42T - 368
CARPET TILE
24" X 24" (VA)
ELEVATOR LOBBIES



CP-12 ALT
HG46T - 368
CARPET TILE
24" X 24" (VA)
MEETING



CP-13 ALT
HG50T - 618
CARPET TILE
24" X 24" (VA)
BOH

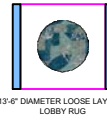

PA-900
HG52R - 368
13'-6" DIAMETER LOOSE LAY RUG
LOBBY RUG

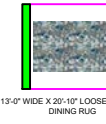

PA-901
HG54R - 368
13'-0" WIDE X 20'-10" LOOSE LAY RUG
DINING RUG



PA-902
HG56R - 368
10'-6" WIDE X 12'-0" LOOSE LAY RUG
PREFUNCTION RUG



BF-01
ACCORE
FAWN ELM
LUXURY VINYL TILE
7" X 48" @ ASHLAR)
GUESTROOM (OPTION)



RE-11
ACCORE
FAWN ELM
LUXURY VINYL TILE
7" X 48" @ ASHLAR)
BOH

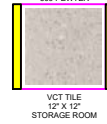

VCT-10
VCT II
509 PEWTER
VCT TILE
12" X 12"
STORAGE ROOM

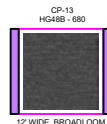

CP-13
HG48B - 680
12" WIDE BROADLOOM
36" X 36" REPEAT
STAIRS



CP-50
HG58R - 368
12" WIDE BROADLOOM
144" X 214.40" REPEAT
LOBBY (RENOVATION)



CP-51
HG60R - 368
12" WIDE BROADLOOM
144" X 111.20" REPEAT
DINING & PREFUNCTION (RENOVATION)

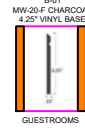

B-01
MW-20-F CHARCOAL
4.25" VINYL BASE
GUESTROOMS

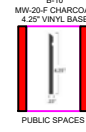

B-10
MW-20-F CHARCOAL
4.25" VINYL BASE
PUBLIC SPACES

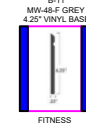

B-11
MW-48-F GREY
4.25" VINYL BASE
FITNESS

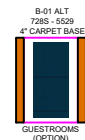

B-01 ALT
728S-1529
4" CARPET BASE
GUESTROOMS (OPTION)

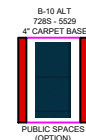

B-10 ALT
728S-1529
4" CARPET BASE
PUBLIC SPACES (OPTION)

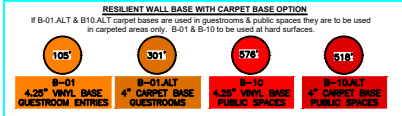
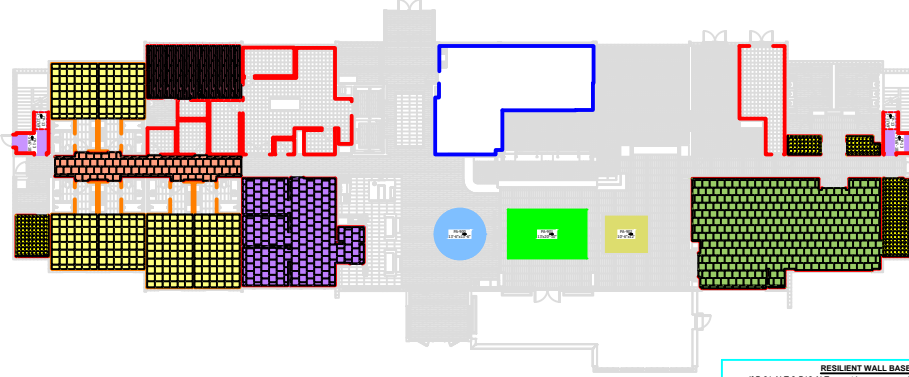
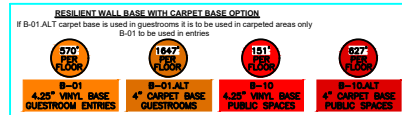
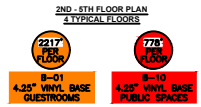
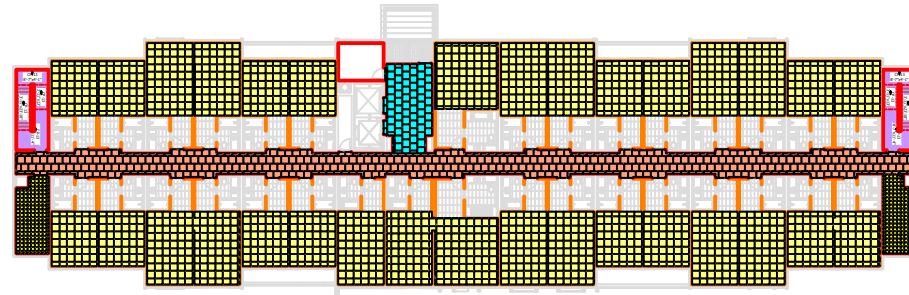
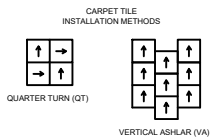

GENERAL NOTES

- 1) This drawing and designs contained therein are the sole property of Tarkett Hospitality Carpet Mills, Inc.
- 2) The red dotted lines indicate known seams. Due to roll sizes and unexpected conditions that may arise, adjustment seams may become necessary during installation. Locations of cross seams are approximate. Actual layout may vary based on roll sizes.
- 3) All contractors using this drawing will be responsible for verifying all dimensions and yardage requirements. Tarkett Hospitality Carpet Mills, Inc. will not be held responsible for final yardage requirements.
- 4) These drawings are used to show the interior design intent only and should not be used for construction purposes.
- 5) Patterned Products require experienced and knowledgeable installation technicians. Please ensure that installers have proper equipment and are familiar with Tarkett's Installation Guidelines. Please contact Technical Services for questions to request a copy of the Installation Guidelines.
Doye Daughler @ (706) 661-3554
John Cox @ (706) 260-3054

Seam Lines are indicated by red dashed lines.
This plan must be field verified for measurement accuracy.

Rev. #	Description	Date

Approved By: _____
Date: _____



TARKETT HOSPITALITY
285 KRAFT DRIVE
DALTON, GA. 30721
(800) 871-3211

Project Name and Address
HILTON GARDEN INN
SPASH PROTOTYPE
CARPET TILE

Every step matters

Sustainability

Every Step Matters. Tarkett's holistic approach to sustainability is woven into the fabric of how we do business and sits at the heart of our day-to-day decision making. For decades, we've scrutinized every detail of our business for its impact on resources such as soil, water, air, and climate—because when you're trailblazing a more sustainable future, every step matters.

Corporate Transparency is fundamental to our values and the way we do business. Third-party assessments serve as a testament to our performance, earning the trust of customers and partners.



EcoVadis

Tarkett is proud to have been awarded a Platinum sustainability rating by EcoVadis with a score of 81/100, which places us in the top 1% of rated companies. EcoVadis assesses CSR policies, actions, and results across four themes and 21 CSR criteria: environment, labor and human rights, ethics, and sustainable procurement.



Carbon Disclosure Project (CDP)

Tarkett's "A" score for climate change impact positions us at the leadership level of CDP's grading system.



Science Based Targets Initiative

Tarkett's 2030 carbon reduction targets are approved by the Science Based Targets initiative (SBTi). We have two 2030 targets guiding nearly every sustainability initiative at Tarkett:

1. Reduce carbon emissions by 30% across Scopes 1, 2, and 3.
2. Increase recycled content in our products from 18% in 2019 to 30% by 2030.



Start your next project with ReStart®

We're committed to creating a circular economy where nothing goes to waste. Take part by starting your next project with Tarkett's ReStart® flooring take-back and recycling program. The ReStart program will accept any type of flooring from any manufacturer. Join us as we innovate and collaborate towards a healthier future for this generation and generations to come.

Contact Us

Firstname Lastname

Title Goes Here

HiltonOrders@tarkett.com

800-871-3211



Tarkett Hospitality
285 Kraft Drive
Dalton, GA 30721
800.871.3211
www.tarketthospitality.com